



BRIDGE FAUCET WITH CROSS HANDLES AND SIDESPRAY

Perrin & Rowe® Kitchen

U.4763X-2

FEATURES

- Cross handles
- Brass construction
- 1/4-turn ceramic disc valves
- 11" reach swivel spout
- Insulated brass sidespray
- 2 3/8" max. installation depth on deck
- 1.8 GPM
- Cannot use any other deck or wall union
- Patented diverter system
- 8" centers
- Hot and cold mix at sidespray
- Cutout: min. 1 1/8" max. 1 3/8"

COLORS/FINISHES

- Polished Chrome
- Polished Nickel
- Satin Nickel
- English Gold*
- English Bronze
- Satin English Gold*
- Unlacquered Brass**

WARRANTY

- Limited Lifetime
- (*) 5-Year Limited Warranty
- (**) No Warranty

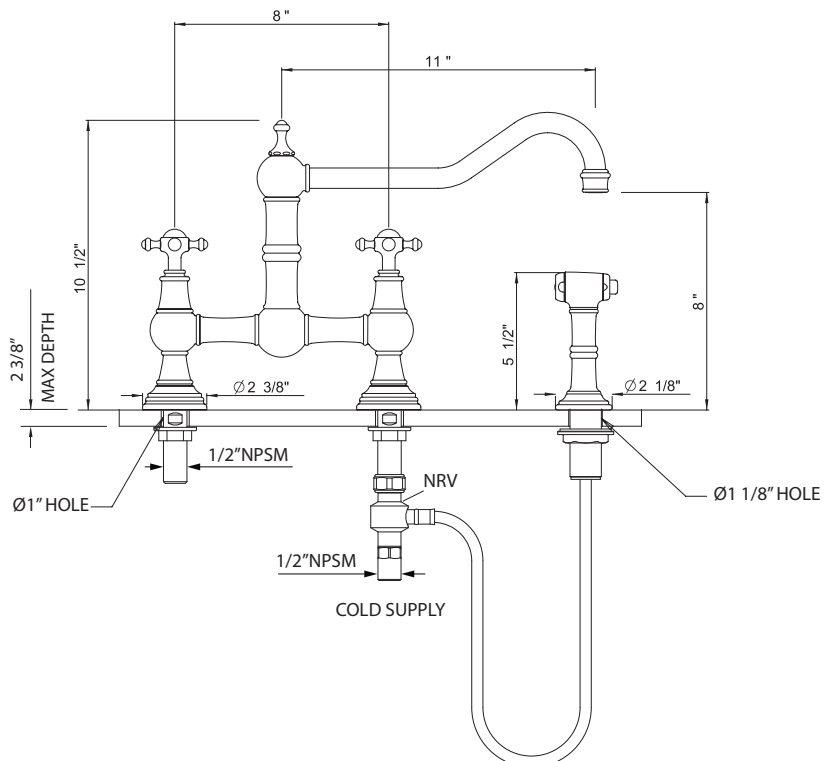

U.4763X Spare Parts

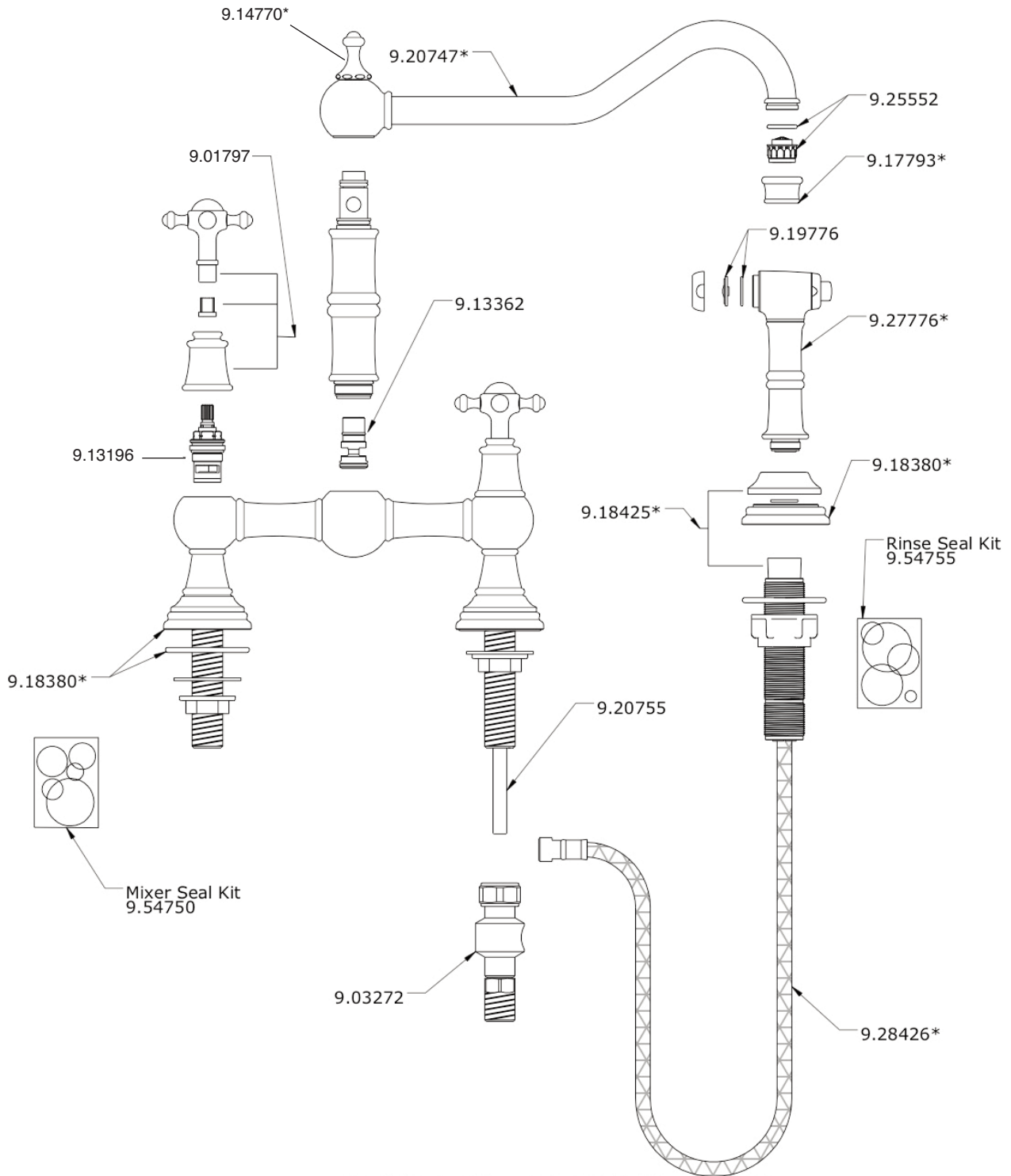

Consult your local House of Rohl showroom for additional information and specifications. For complete warranty details and a list of showrooms, go to houseofrohl.com

Installation Instructions

PERRIN & ROWE
MAYFAIR LONDON

The Country Kitchen Collection
Installation & User Guide

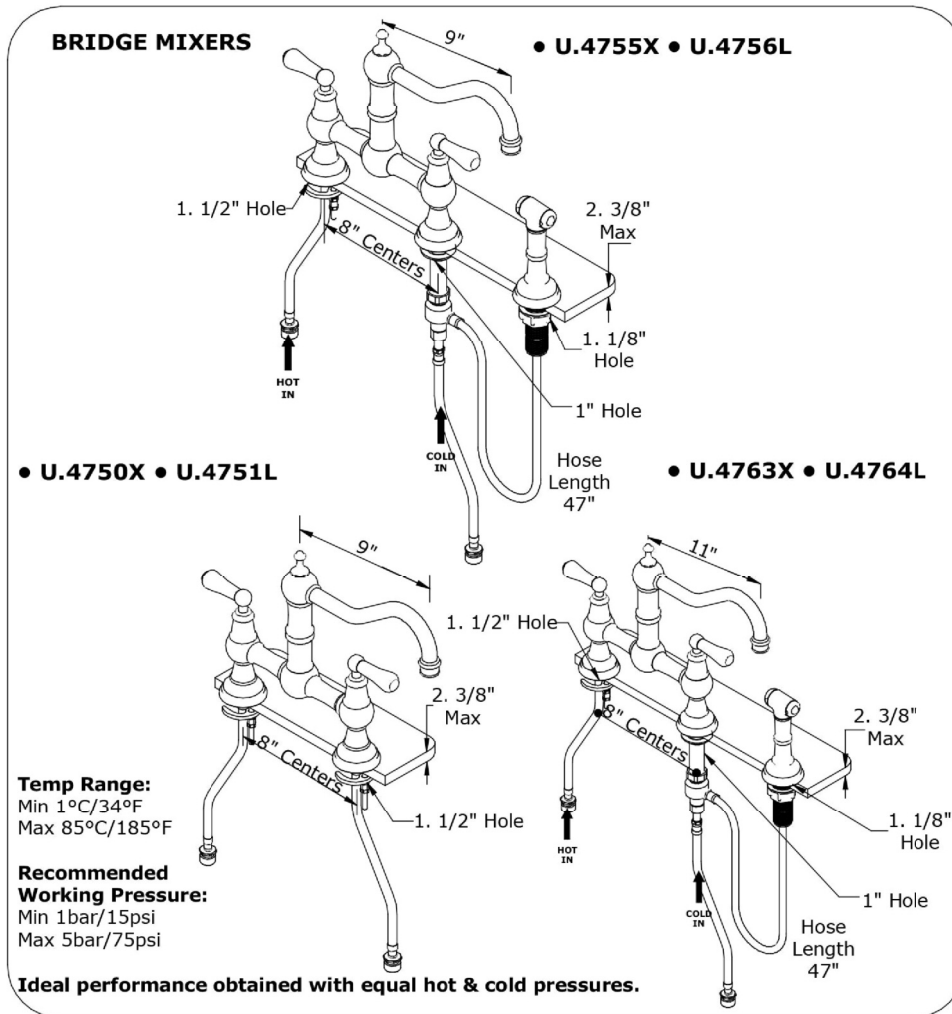

Installation Instructions

The Country Kitchen Collection Installation & User Guide

Congratulations on the purchase of your Perrin & Rowe Kitchen Product. Correctly installed and with sensible care, this product will give you many years of trouble free service.

IMPORTANT INFORMATION

Before you proceed... We recommend you engage the services of a registered plumber to install this product.

For ease of possible future servicing, we also recommend the fitting of conveniently placed isolating valves.

In addition to the guide below it is essential that the written information overleaf is carefully read and understood.

Preparation Check Box for Installer

Flush the plumbing system before installing the kitchen product.

Once unpacked remove Back nuts, Securing Clamp and Side Spray Connector ready for installation.

1

Ensure the mixer is orientated correctly, levers should rotate to point forward. After removing backnuts, place complete faucet through $\text{Ø}1\ 3/4''$ holes at $7\ 7/8''$ centers (do not remove unions from body) - product is fitted with straight unions, distance must be exact. Secure mixer with a suitable faucet wrench.

The kitchen faucet with side spray is supplied with a brass tube protruding out of the bottom of the shank. Please be careful not to damage the end of this tube during installation.

If your mixer has a side spray please follow steps 2,3 & 4 to install correctly, otherwise please connect Hot & Cold water supplies to shanks.

Ensure all connections are firmly tightened

2: Install hose through deck escutcheon.

Secure side spray unit socket in a suitable position using a faucet wrench.

Place flexible hose through top of side spray unit socket as shown in diagram.

3: Rotate rinse connector on hose before connecting to union.

Install washer "B" to install hose.

Install washer "A" to connect to the cold water supply.

Rotate side spray connector onto end of flexible hose. Do not twist hose. Loosen, but do not remove the gland nut.

Ensure connection is firmly tightened.

Installation Instructions

4: Attach Connector

The side spray connector must be installed on the hose before mounting on the cold side shank.

Important - Do not cut brass tube.

With washer in place on the captive nut push connector onto cold supply 3/8" tube as shown. Fully tighten captive nut onto shank, taking care not to twist hose.

Tighten the gland nut to fully compress the seals onto brass tube.

With washer in place hold the side spray, screw the flexible hose onto the end of side spray and place into side spray unit socket. Make sure orientation of side spray is correct.

Ensure all connections are firmly tightened.

Please Note: Ceramic disc valves are fitted as standard to this mixer. Flow from FULLY OFF to FULLY ON is achieved by rotating the handles a quarter turn.

Please Note: Ceramic disc valves are fitted as standard to this mixer. Flow from FULLY OFF to FULLY ON is achieved by rotating the handles a quarter turn.

Please note: If there is a low flow at the hand spray, reinstall the side spray connector: Remove the hose and follow the instructions in step 3.

BEFORE USE

- Carefully check the installation for leaks.
- If further building work is to be carried out in the vicinity, cover the tap with a plastic bag to avoid damaging the finish.
- Please ensure that the installation complies with local plumbing codes.

CARE & MAINTENANCE

Wipe down after use to avoid water spotting and mineral build up.

Occasional cleaning with warm soapy water, followed by a polish with a soft cloth is all that is required to keep the plated finish in good condition.

Do not use proprietary abrasive liquids, powders, or pads to clean the shower. Do not use any products with ammonia bleach or limescale remover. You will damage the plated finish and void your guarantee.

Installation Instructions

ROHL WARRANTY POLICY

All products supplied by ROHL carry warranties against manufacturing defects.

Perrin & Rowe products carry a Limited Lifetime Warranty.

ROHL LLC will provide free of charge, as its options, replacement part(s) or product (or a comparable alternative product) to replace those which have proven defective in materials or workmanship.

For full ROHL LLC WARRANTY please contact ROHL or visit www.rohlhome.com

SPARES

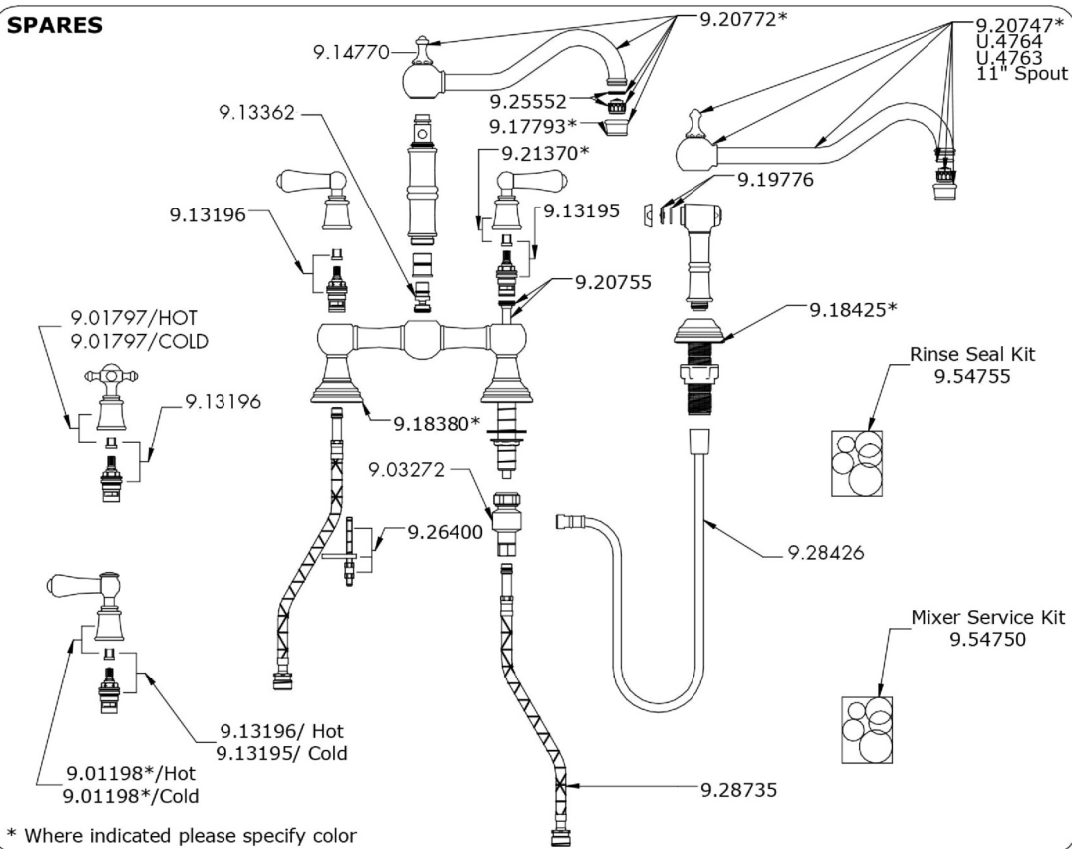

SPARE PARTS & SERVICE

ROHL

Authentic Luxury for Kitchen and Bath™
3 Parker
Irvine
CA 92618
(714) 557-1933

www.rohlhome.com

Perrin & Rowe products are manufactured in the UK, using the latest technology and built to the highest quality standards.

We would like to thank you for purchasing a Perrin & Rowe product and take this opportunity to invite you to look at other luxury products by us. Please contact us to receive our latest catalogue.