

MONTE CARLO

FAN COLLECTIONS

ESSWC-11 WALL CONTROLLER INSTALLATION AND OPERATION INSTRUCTION



SAFETY INFORMATION AND GENERAL GUIDE

READ AND SAVE THESE INSTRUCTIONS

- Please read and understand this entire manual before attempting to assemble, install or operate the product.
- Make sure that all electrical connections comply with local codes, ordinances, the National Electrical Code and ANSI/NFPA 70. Hire a qualified electrician or consult a do-it-yourself wiring handbook if you are unfamiliar with installing electrical wiring.

Warning: Before proceeding, be sure to shut off electricity at main switch or circuit breaker in order to avoid electrical shock.

Note: Fan installation must be complete including assembly of blades before testing wall control unit.

Note: Refer to your Ceiling fan instruction manual for Safety and installation instruction.

This wall controller is to be used for the control of ceiling fan and fan light only.

Warning: Do not exceed maximum rating of the wall controller. Install the wall controller away from excess heat or humidity

Customer Service
800-969-3347

Customer Service Center
7400 Linder Ave.
Skokie, IL 60077
www.montecarlofans.com





Wall Transmitter Installation, Wiring and Setting

Warning: Before proceeding, be sure to shut off electricity at main switch or circuit breaker in order to avoid electrical shock.

Make series-wound connection for the wall controller with HOT wire from house. Connect the black wire (AC IN L) from wall controller to the HOT wire from house and then connect the other black wire (To Motor L) to the LOAD wire from fan in outlet box. Connect blue wire (For light) from wall controller to the blue wire from fan.

Connect white wire from fan to Neutral wire from house.

Connect all green grounded wires.

(Fig. 1)

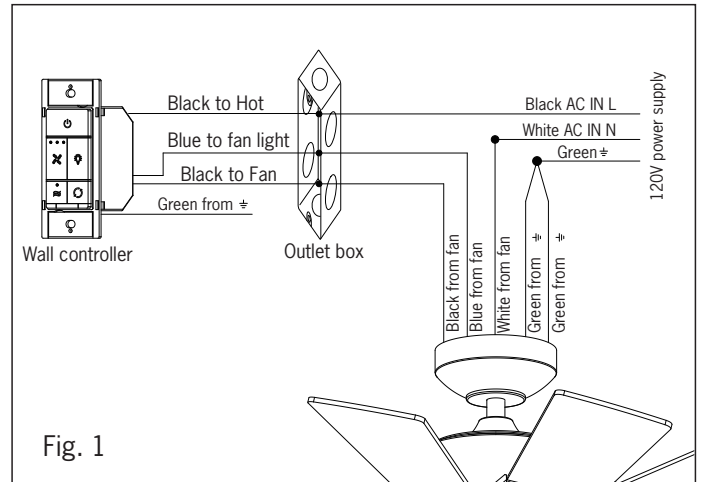

Install the wall controller to outlet box using machine screws provided.

Attach the wall plate to wall control unit with screws provided. (Fig. 2)

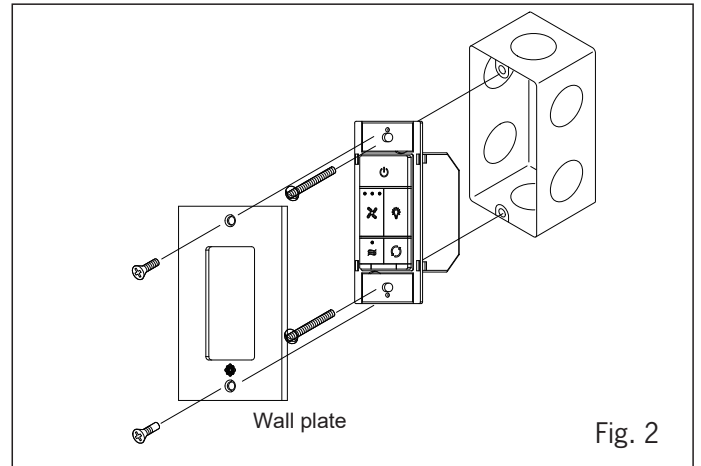



WALL CONTROLLER OPERATION

The buttons on the wall controller control the fan speed and light as follows.

(Fig. 3, 4)

 This button switches the power on or off. Push the button to have the power on and pull it (or pry it up by fingernail if needed) up to turn power off. (Fig.3)

Note: Before installing the wall controller, place it at the off position. Turn the power back on for operating the controller.

Note: Make sure the fan and light are set to the ON position by the pull chain switches with your fan

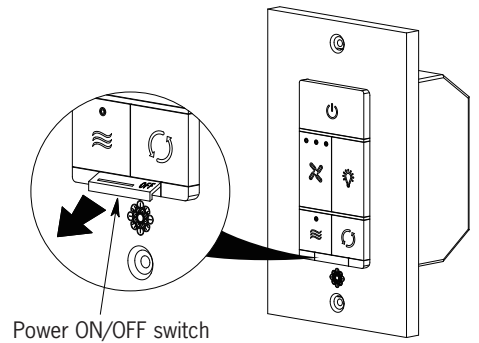





Fig.3

Fan speed

- low speed (1st) ●●○ medium speed (2nd)
- high speed (3rd) ○○○ Fan off

 This button turn fan on or off.

 Press the button to get desired fan speed, Low, Medium, High cyclically.

 Press this forward/reverse button to get desired airflow direction. Fan must be running to reverse. It will take about 25 seconds for fan to slow down and change rotation direction.

 Press this button quickly to turn light on or off. To dim light, hold down the button, the light will cycle from bright to dim to bright until button is released.

 Press the Breeze button, the fan will operate at 2-3-2-1-2 speed at intervals of 60 seconds until the breeze mold is canceled. Breeze mode can be erased by pressing the buttons of breeze, power or speed control

Note: This controller has auto resume function, the fan and light will maintain the last setting if turned off with exception of the Breeze mode.

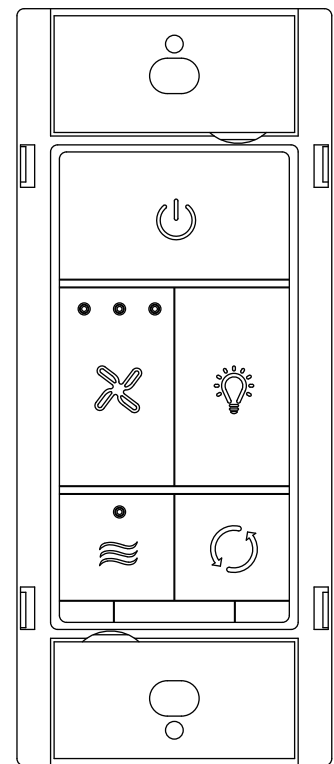

Fig.4

User Tips

1. If your fan is operating automatically after installation, it is still using the factory setting. Follow the settings for Learn Mode above to reset.
2. When the fan is turned on to oscillate in either forward or reverse direction, it may shudder briefly until fully engaged. This is a normal operation for this fan; the shuddering will quickly cease as movement is engaged.

THIS DEVICE COMPLIES WITH PART 15 OF THE FCC RULES OPERATION IS SUBJECT TO THE FOLLOWING TWO CONDITIONS. (1)THIS DEVICE MAY NOT CAUSE HARMFUL INTERFERENCE AND (2) THIS DEVICE MUST ACCEPT ANY INTERFERENCE RECEIVED, INCLUDING INTERFERENCE THAT MAY CAUSE UNDESIRED OPERATION.

Jun.2021