

American Standard

HERITAGE
AMARILIS

SINGLE-HOLE BAR/PANTRY FAUCET WITH SWING SPOUT

*Thank you for selecting American-Standard...
the benchmark of fine quality for over 100 years.*

*To ensure that your installation proceeds smoothly—
please read these instructions carefully before you begin.*

**Installation
Instructions**
7100.2XX
7190.132



Certified to comply with ANSI A112.18.1M
U.S. Patent No. 5,819,789
34440 REV. 1.6 (5/16)

MODEL 7190.132

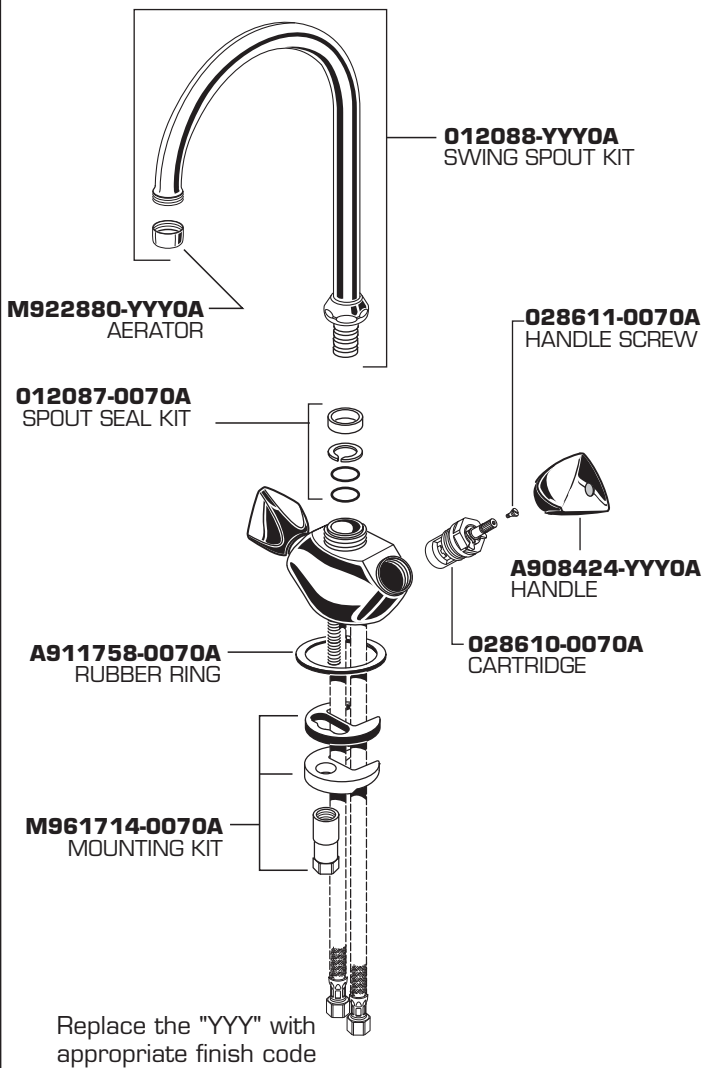

MODEL 7100.2XX

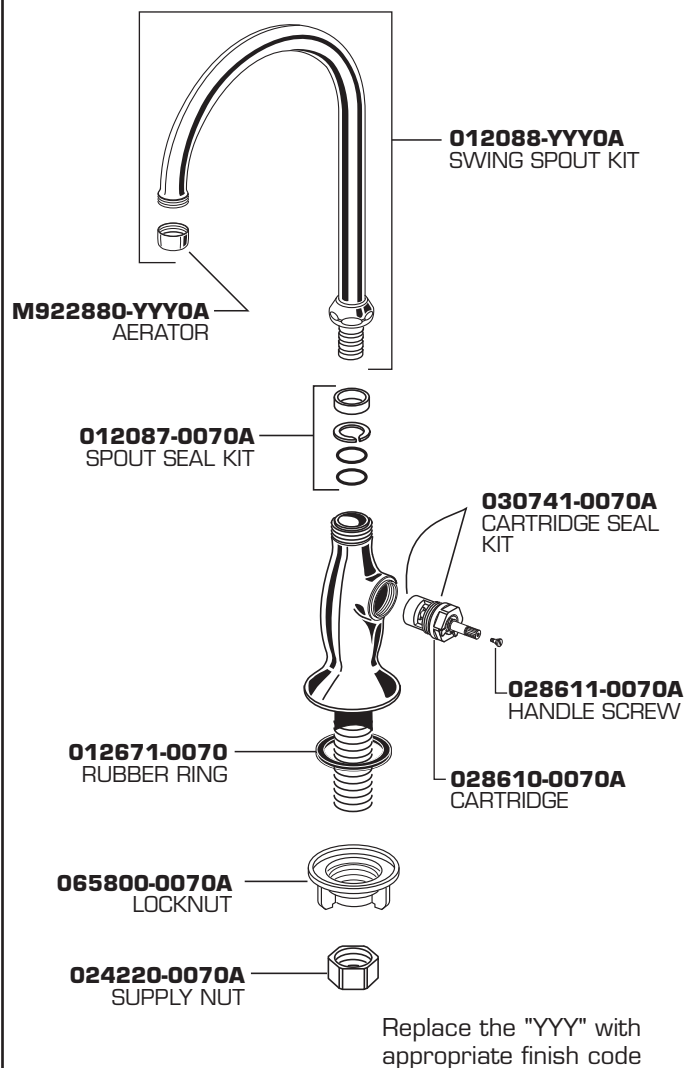

CHROME	002
POL. BRASS	099
SATIN NICKEL	295
SATIN/BRASS	297
CHROME/POL. BRASS	299



HOT LINE FOR HELP

For toll-free information and answers to your questions, call:
1-800-442-1902
Mon. - Fri. 8:00 a.m. to 6:00 p.m. EST
Saturday 10:00 a.m. to 4:00 p.m. EST
IN CANADA 1-800-387-0389 (TORONTO 1-905-306-1093)
Weekdays 8:00 a.m. to 7:00 p.m. EST
IN MEXICO 01-800-839-1200

Product names listed herein are trademarks of American Standard Inc. © AS America, Inc. 2016

CHROME	002
WHITE	020
BONE	021
POL. BRASS	099

PART OF LIXIL

1

SWING SPOUT ASSEMBLY

CAUTION

Turn off hot and cold water supplies before beginning.

- Assemble the SPOUT (3) and tighten the SPOUT NUT (4) until snug on VALVE BODY.

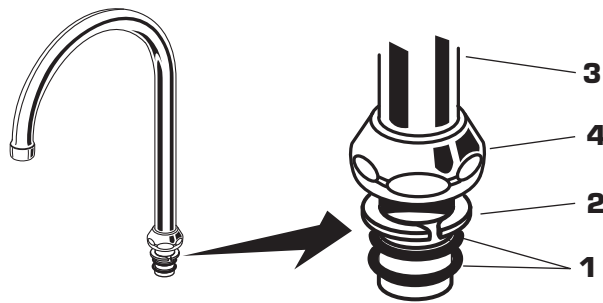

2

FITTING INSTALLATION

- Remove LOCKNUT (1), BRASS WASHER (2), and GASKET (3) from fitting.
- Place RUBBER RING (4) in recess of fitting.
- Insert inlet hoses (on model 7190.132 only) and THREADED SHANK through hole of sink making certain RUBBER RING (4) is properly seated in the recess of the fitting base.
- Assemble GASKET (3), BRASS WASHER (2), and LOCKNUT (1) onto the THREADED SHANK from underside of sink deck.
- Tighten the LOCKNUT (1) securely.

For Model 7190.132 Only

- Connect the hot water supply to the left inlet hose and the cold water supply to the right inlet hose using appropriate connectors.

For Model 7100.2XX Only

- Connect hot or cold water supply lines to shank using sealant, appropriate connectors, and coupling nuts.

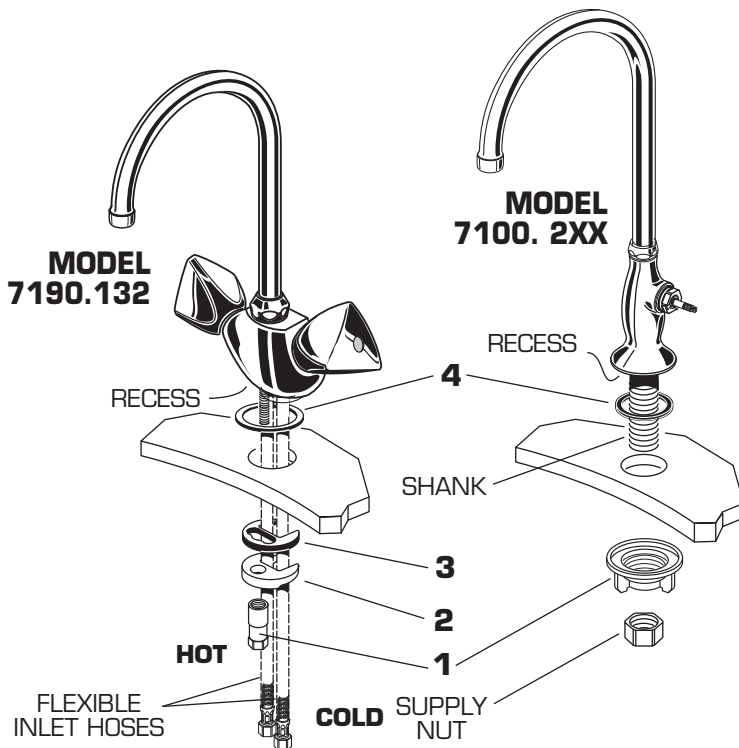

3

TEST INSTALLED FAUCET

- Remove AERATOR.
- With handle in OFF position, turn on water supplies and check all connections for leaks.

- Operate both handles to flush water lines thoroughly. Checkspout mounting and hose connections for leaks.
- Turn handles into OFF position and replace AERATOR.

4

SERVICE

- To change direction of handle rotation, proceed as follows:
 - Turn valve to OFF position.
 - Remove INSERT and HANDLE SCREW.
 - Slip HANDLE with ADAPTER off.
 - Remove SPRING CLIP (1).
 - Lift STOP WASHER (2), turn 90° and replace.
 - Replace SPRING CLIP (1).
 - Replace ADAPTER, HANDLE, SCREW, and INSERT.

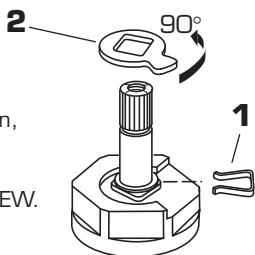

- AERATOR may accumulate dirt causing distorted and reduced water flow. Remove AERATOR and rinse clean.
- If spout drips, operate handles several times from OFF to ON position. Do not force - handles turn only 90°.

- Plastic SCREEN (3) in CARTRIDGE (4) may accumulate dirt causing reduced water flow. To clean, first turn off hot and cold water supplies, then:

- Remove INSERT and HANDLE SCREW.
- Slip HANDLE with ADAPTER off.
- Unscrew CARTRIDGE (4) with wrench.
- Thoroughly rinse plastic SCREEN (3) at base of CARTRIDGE (4).
- Replace CARTRIDGE (4) until flange is tight against valve body.
- Turn valves OFF.
- Replace ADAPTER, HANDLE, SCREW, and INSERT.

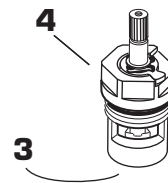

5

CARE INSTRUCTIONS:

DO: SIMPLY RINSE THE PRODUCT CLEAN WITH CLEAR WATER. DRY WITH A SOFT COTTON FLANNEL CLOTH.

DO NOT: DO NOT CLEAN THE PRODUCT WITH SOAPS, ACID, POLISH, ABRASIVES, HARSH CLEANERS, OR A CLOTH WITH A COARSE SURFACE.